

Setting Blocks "On-Point"

Assembling Diagonal Settings

To assure success with diagonal settings, whenever possible our instructions have you cut (or make) slightly oversized edge and corner setting triangles. Quilt edges will be trimmed after assembly to even them up, and the oversized setting triangles allow you to trim without cutting into adjacent blocks or patches. Our photos show simple Nine-Patch Blocks in a diagonal setting; contrasting thread was used for visibility.

On a design wall or other flat surface, arrange the blocks, quarter-square (edge) setting triangles, and half-square (corner) setting triangles in diagonal rows for the quilt center (Photo A).



For the 1st diagonal row, pin block and setting triangle right sides together, aligning the block and the 90° corner of the triangle (Photo B). Notice that the triangle points extend beyond the block.

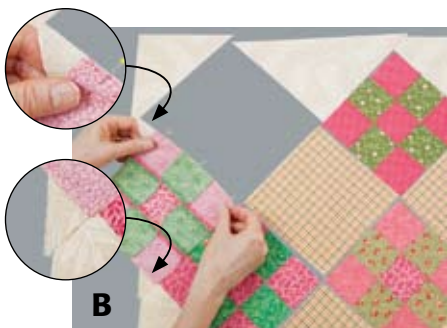

Sew 1/4" seam, press seam allowances toward triangle, and place the joined triangle/block back into the arrangement (Photo C).



In similar manner, pin and sew 2nd edge setting triangle to block (Photo D) to complete 1st diagonal row.



Sew the remaining diagonal rows, adding any edge triangles (Photo E), and leaving off corner setting triangles for now. (Plan your pressing so seam allowances will lie in opposite directions when rows are joined. In the sample, seams within each row are pressed away from the pieced blocks.)



Pin 1st and 2nd diagonal rows together (Photo F), aligning seams and keeping in mind that edge setting triangles will extend beyond adjoining patches and blocks.



Sew 1/4" seam (Photo G), open and press, and place back into the arrangement.



In similar manner, join remaining diagonal rows (Photo H). Press.



Assembling Diagonal Settings

Finger-press corner setting triangle in half, and gently crease or insert a pin to mark center of long edge (**Photo I**). Mark center of the corresponding block or square in the same way.



Matching marked centers (**Photo J**), pin corner triangle to the quilt (triangle points will extend beyond seam line).



Sew $\frac{1}{4}$ " seam (**Photo K**). Open and press.



Repeat to add all 4 corner setting triangles (**Photo L**). Press quilt center.



Trim quilt edges even in the following manner. Align $\frac{1}{4}$ " line on ruler (or other measurement called for in pattern instructions) slightly outside corner of 2 or more blocks (**Photo M**); trim away excess fabric. Move ruler as necessary to complete trimming 1st edge of quilt.



Rotate quilt, align ruler as before, and align a perpendicular line on ruler with previously cut edge (**Photo N**) to ensure trimming corner at a 90° angle. **Trim.**



Repeat to trim all edges (**Photo O**).

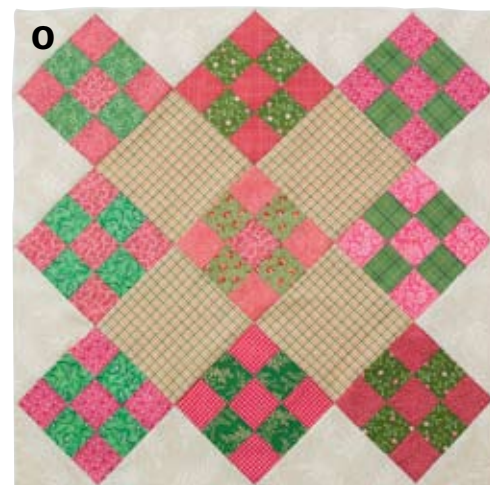

Calculating Setting Triangle Size

Setting quilts on point requires the addition of "setting triangles" on the sides and corners. To ensure that the straight grain of the fabric is on the outer edges of the quilt, cut quarter square side setting triangles and half square corner setting triangles.

Rows are assembled diagonally, starting at the corner. Corner setting triangles are added after rows have been sewn together. **TIP:** Spray bias edges lightly with fabric sizing (not starch) to help prevent them from stretching.

Setting Triangles Examples

Measurements include seam allowance. Blocks set together with no sashing.

Finished Size	Corner	Side
6" Block	$5\frac{1}{8}$ "	$9\frac{3}{4}$ "
10" Block	8"	$15\frac{3}{8}$ "
12" Block	$9\frac{3}{8}$ "	$18\frac{1}{4}$ "

Setting Triangles Calculations

Use the following formulas for calculating setting triangle measurements for other size blocks. Round measurements to the nearest $\frac{1}{8}$ ". Remember to add finished sashing measurement to block size when figuring size for setting triangles on a sashed quilt.

Corner Setting Triangles (Half Square):

... Finished size of block (e.g. 15") $\div 1.414 + .875 =$ CUT SIZE OF SQUARE

Side Setting Triangles (Quarter Square):

... Finished size of block (e.g. 15") $\times 1.414 + 1.25 =$ CUT SIZE OF SQUARE

Determine Finished Size of Quilt

Use the diagonal measurement to determine how many blocks you will need for the quilt. If you are using a 10" block the measurement would be $14\frac{1}{8}$ " (10×1.414). **Example:** Four blocks across and five down measures $56\frac{1}{2}$ " $\times 70\frac{5}{8}$ " before the borders are added.