

# Fairy Ring Block

## SKILL LEVEL

**CONFIDENT BEGINNER**

## Finished Block Size

12" x 12"

**Note:** Templates A and B are at end of pattern.

## Cutting Instructions

Heavy paper or cardstock (paper hexagons)

13 Template A\*

Light green/pink floral (hexagons)

6 Template B

3 assorted light green prints (hexagons)—**cut from each:**

2 Template B

Novelty fabric (center hexagon)

1 Template B

Dark green mottle (block background)

1 square 13" x 13"

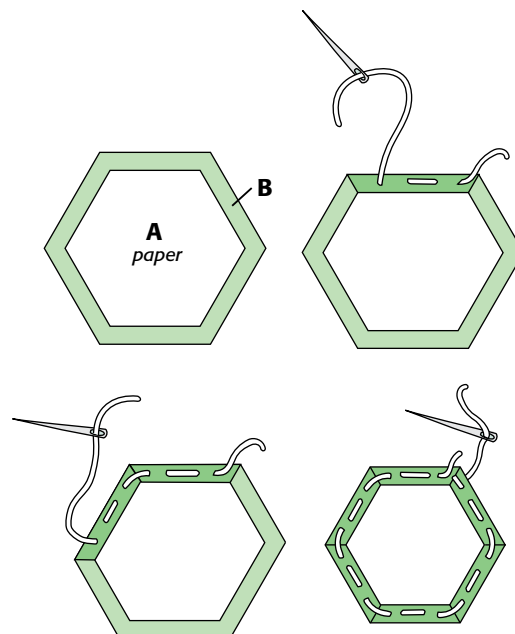
\*You may prefer to purchase paper hexagons that are 1¼" on a side, rather than making your own. [Paperpieces.com](http://Paperpieces.com) is one website that carries paper hexagons this size.

## Making the Block

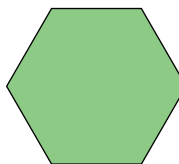
**1** Trace Template A on heavy paper or cardstock. Cut out on marked line to make paper hexagon. Make 13.

**2** Referring to **Diagram I**, place paper hexagon on wrong side of fabric B, centering. Fold edges of B over A and baste in place, stitching through fabric and paper, to make basted hexagon. Make 13 total (**Diagram II**).

**3** Align 2 basted hexagons, right sides together, and whip-stitch one edge, taking tiny stitches that just catch fabric folds (**Diagram III**). Hexagons should lay flat when opened.

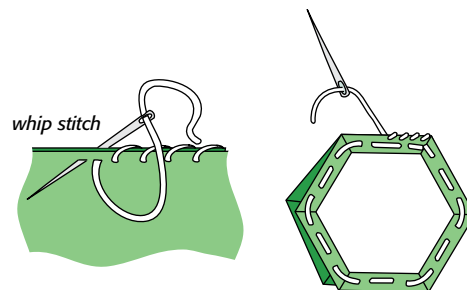


**Diagram I**



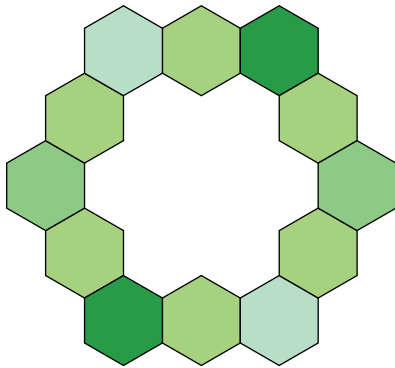
Make 13 total

**Diagram II**



**Diagram III**

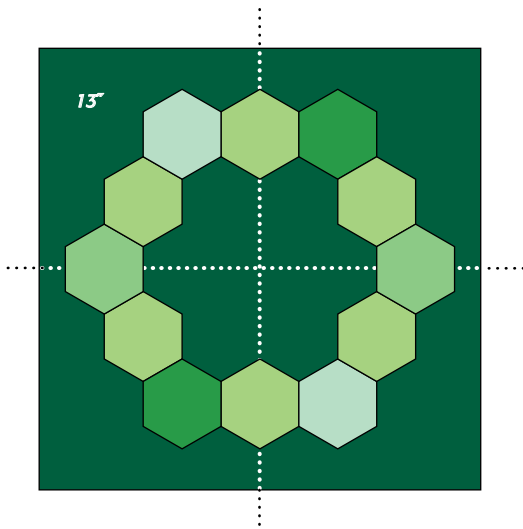
4 Referring to **Diagram IV**, whip-stitch together 6 green/pink floral and 6 assorted green print basted hexagons, alternating and being sure to sew correct edges together to form ring. Make 1. With right side down, spray ring with starch or starch alternative and press with papers still in place. When ring is cool remove basting and papers, keeping outer edges of hexagons folded under. In same manner, starch and press remaining hexagon and remove paper. Papers can be reused.



Make 1

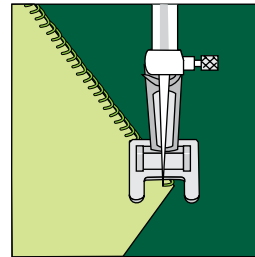
**Diagram IV**

5 Fold green mottle 13" square in half on both length and width; use folds as placement guide. Center ring on green mottle square and pin or baste in place (**Diagram V**).



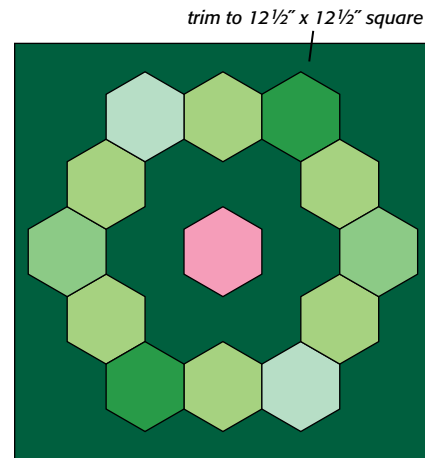
**Diagram V**

Using machine blanket stitch (**Diagram VI**), edge-stitch ring in place. You may wish to use a wool or other thick thread for extra visibility.



**Diagram VI**

6 Center novelty fabric hexagon in ring and machine blanket stitch in place. Press square, and trim to 12½" x 12½", centering ring, to complete Fairy Ring Block.



**Diagram VII**

