

# Celtic Twist Block

**Skill Level**  
CONFIDENT BEGINNER

**Finished Block Size**  
12" x 12"

**Cutting Instructions**  
(cut in order listed)

White/green print (background)

4 rectangles  $3\frac{1}{2}$ " x  $6\frac{1}{2}$ "

1 square  $3\frac{1}{2}$ " x  $3\frac{1}{2}$ "

4 squares 2" x 2"

Dark green swirl print, medium lime mottle, light green floral, and dark green texture (links)—cut from each:

1 strip 2" x 5"

1 rectangle 2" x  $3\frac{1}{2}$ "

3 squares 2" x 2"

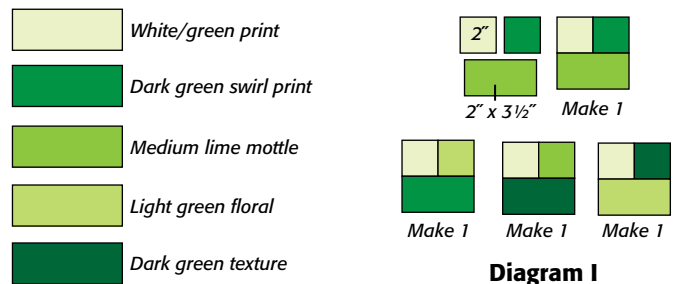
**Piecing the Block**

**1** Referring to **Diagram I**, sew together 1 white/green print 2" square, 1 dark green swirl print 2" square, and 1 medium lime mottle  $2\frac{1}{2}$ " x  $3\frac{1}{2}$ " rectangle to make pieced square. Make 4 total in fabric arrangements shown.

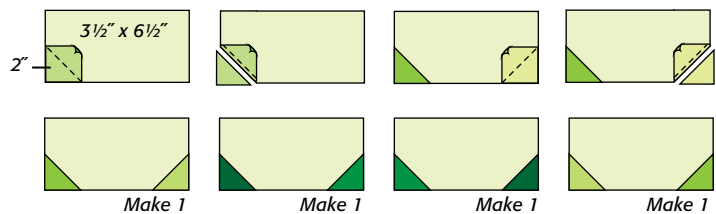
**2** Draw diagonal line on wrong side of lime 2" square. Place marked square on white/green  $3\frac{1}{2}$ " x  $6\frac{1}{2}$ " rectangle, right sides together, aligning raw edges (**Diagram II**). Stitch on drawn line; trim away and discard excess fabric. Open and press. Repeat on opposite end of rectangle with light green floral 2" square to make pieced rectangle. Make 4 total in fabric arrangements shown.

**3** Referring to **Diagram III-A** for fabric placement, lay out 2" x 5" strips around white/green  $3\frac{1}{2}$ " square. Stitch first seam as shown, starting approximately 2" (dot) from top left corner of center square. Open strip and press partial seam. Following seaming order, add remaining strips. Complete partial seam to make block center (**Diagram III-B**).

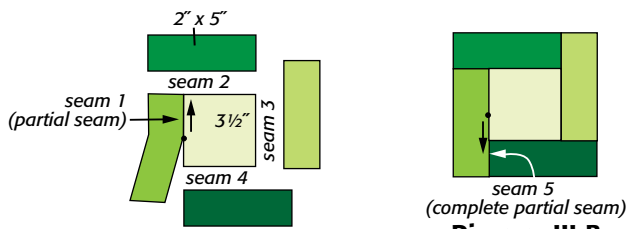
**4** Arrange pieced squares, pieced rectangles, and block center as shown (**Diagram IV**). Check placement to make sure that links appear to interlock. Sew 3 rows, and then sew rows together to make Celtic Twist Block.



**Diagram I**

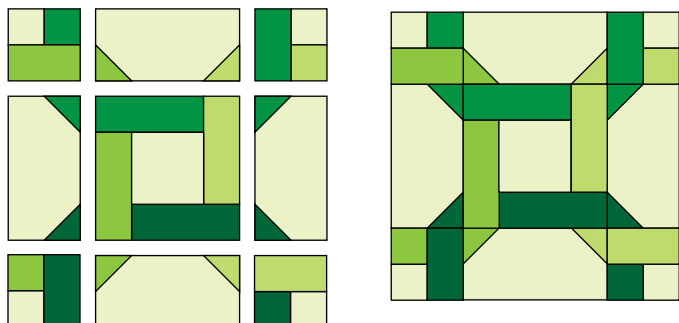


**Diagram II**



**Diagram III-A**

**Diagram III-B**



**Diagram IV**