

# Blueberry Ice Web Bonus: Queen Size

Adapted from a quilt designed by  
**Gerri Robinson**

Finished Quilt Size  
**90½" x 90½"**

Number of Blocks and Finished Size  
**16 Star Blocks 16" x 16"**

## Plan

Beautiful pieced stars are featured in this elegant bed quilt. Each block uses 1 light and 1 dark blue print for the star. Gerri made 2 stars using 2 dark blues each. If you choose to do likewise, designate one fabric as light and one as dark for construction. Navy dot corners in the blocks combine with sashing posts to create a fun secondary design. Be sure to use an accurate ¼" seam allowance so all elements fits together well.

## Shop

Navy dot (block corners, sashing posts, border, and binding)	1 ½ yds.
Cream dot (blocks, sashing, border)	6 ½ yds.
Assorted dark blue prints (blocks)	1 ½-1¾ yds. <b>total</b>
Assorted light blue prints (blocks)	1 ½-1¾ yds. <b>total</b>
Blue floral (outer border)	1 ½ yds.
Backing	8¾ yds.
Batting size	100" x 100"

## Cut

### (in order listed)

Navy dot

- 10 strips 2½" x width of fabric (WOF) for binding
- 125 squares 2½" x 2½"

Cream dot

- 16 strips 4½" x 16½"
- 64 rectangles 4½" x 6½"
- 68 squares 4½" x 4½"
- 40 strips 2½" x 16½"
- 20 rectangles 2½" x 4½"
- 320 squares 2½" x 2½"

Assorted dark blue prints—**cut 16 matched sets of:**

- 2 squares 27⁄8" x 27⁄8"
- 4 rectangles 2½" x 4½"
- 4 squares 2½" x 2½"

Assorted light blue prints—**cut 16 matched sets of:**

- 2 squares 27⁄8" x 27⁄8"
- 4 rectangles 2½" x 4½"
- 4 squares 2½" x 2½"

Blue floral

\*4 strips 4½" x 94", pieced from 10 WOF strips

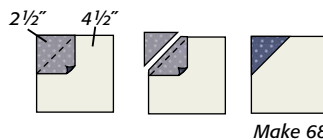
\*Border strips include extra length for trimming.



The Blueberry Ice lap quilt (64½" x 64½") is patterned in the August/September 2014 issue of *McCall's Quick Quilts*.

## Sew

**1** Draw diagonal line on wrong side of navy dot 2½" square. Referring to **Diagram I**, place marked square on cream dot 4½" square, right sides together, aligning raw edges. Stitch on drawn line; trim away and discard excess fabric. Open and press to make pieced square. Make 68.



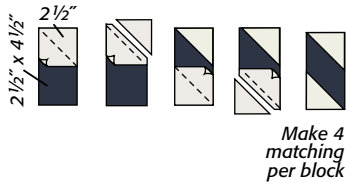
Make 68

**Diagram I**

## Kit Offer

A kit of fabrics for lap sized quilt top and binding is available while supplies last for \$100.00 ppd. (OH residents, \$107.00 ppd.) from Planted Seed Designs, 7430 Kilbriain Ln., Dublin, OH 43017; 614-734-1183; plantedseeddesigns.com. Backing fabric is \$45.00 ppd. (OH, \$48.15 ppd.).

**2 Note:** Block piecing instructions and diagrams are for 1 block only. Draw diagonal line on wrong side of cream dot 2½" square. Referring to **Diagram II-A**, place marked square on dark blue 2½" x 4½" rectangle, right sides together, aligning raw edges. Stitch on drawn line; trim away and discard excess fabric. Open and press. Repeat on opposite end, watching direction of stitching, to make pieced rectangle. Make 4 matching per block. In same manner, make 4 pieced rectangles in opposite orientation using light blue print 2½" x 4½" rectangles (**Diagram II-B**). Make 4 matching per block.

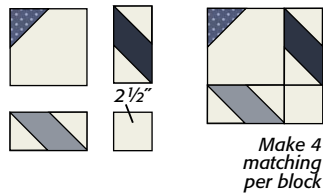


**Diagram II-A**



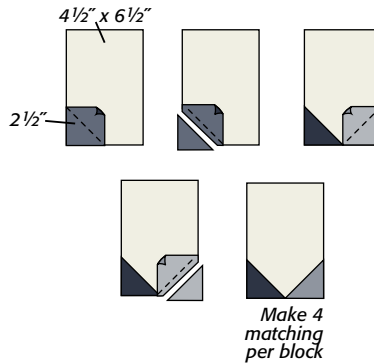
**Diagram II-B**

**3** Referring to **Diagram III**, sew 2 rows using pieced square, 2 pieced rectangles (1 of each fabric), and cream dot 2½" square. Sew rows together to make corner unit. Make 4 matching per block.



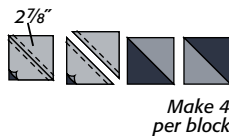
**Diagram III**

**4** Draw diagonal line on wrong side of dark blue 2½" square. Referring to **Diagram IV**, place marked square on cream dot 4½" x 6½" rectangle, right sides together, aligning raw edges. Stitch on drawn line; trim away and discard excess fabric. Open and press. Repeat on adjacent corner with light blue 2½" square. Open and press to make edge unit. Make 4 matching per block.

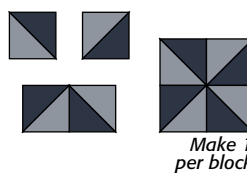


**Diagram IV**

**5** Draw diagonal line on wrong side of light blue 2⅞" square. Referring to **Diagram V-A**, place marked square on dark blue 2⅞" square, right sides together. Sew ¼" seam on each side of marked line; cut apart on marked line. Open and press to make 2 pieced squares. Make 4 per block. Watching orientation, sew together 4 pieced squares to make center square (**Diagram V-B**). Make 1 per block.

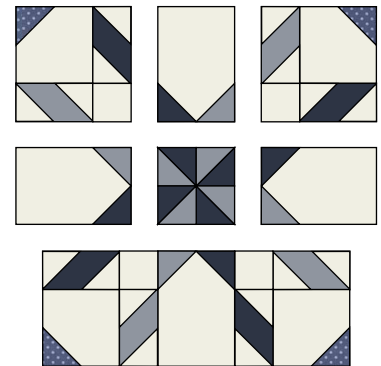


**Diagram V-A**



**Diagram V-B**

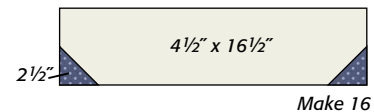
**6** Sew 3 rows using 4 matching corner units, 4 matching edge units, and matching center square (**Diagram VI**). Sew rows together to make Star Block. Repeat Steps 2 through 6 to make 16 total.



*Make 16 total*

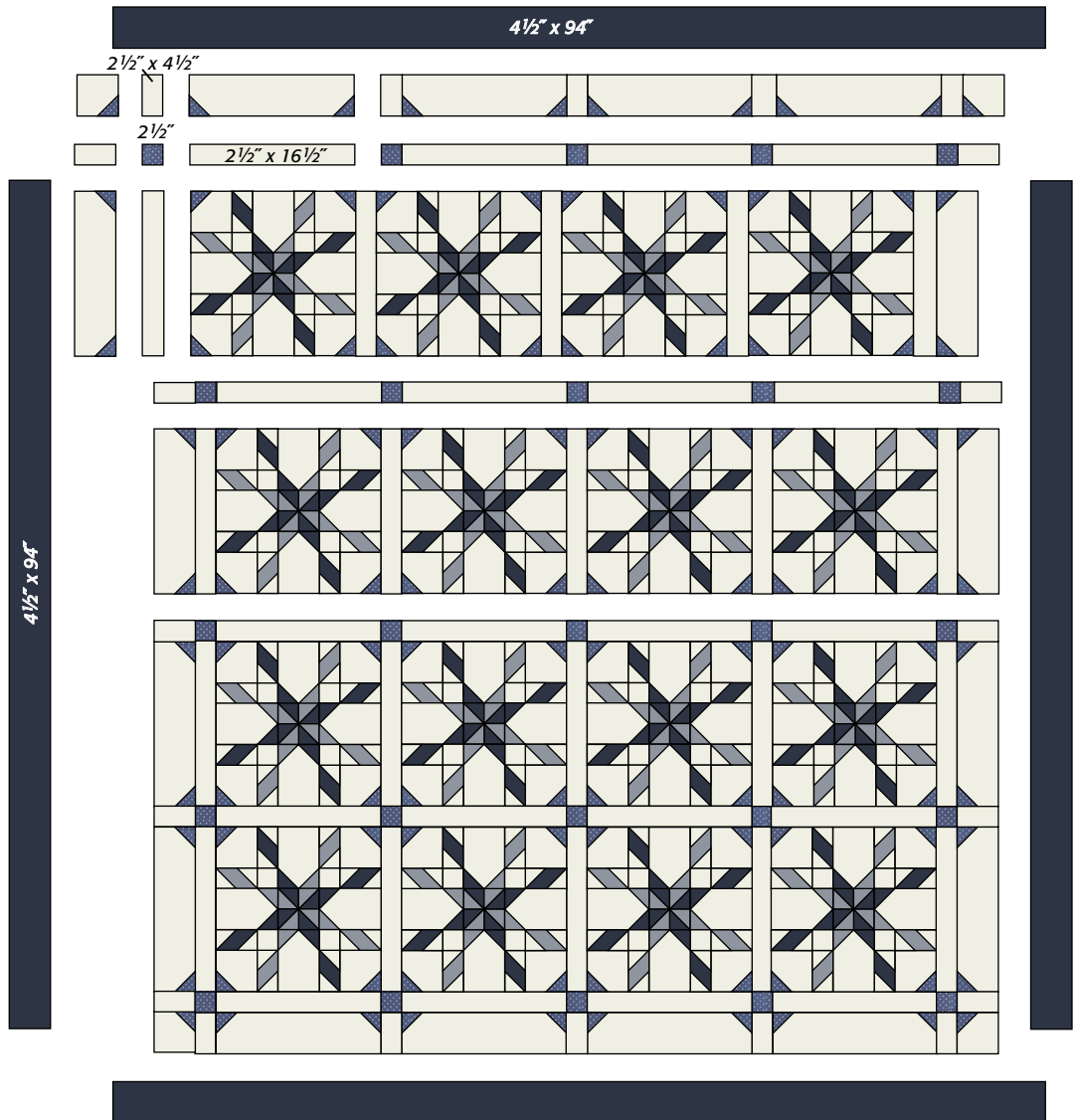
**Diagram VI**

**7** Referring to Step 1 technique and **Diagram VII**, use navy 2½" squares and cream 4½" x 16½" strips to make 16 border units.



**Diagram VII**

- 8 Note:** Refer to **Assembly Diagram** for the following steps. Stitch 5 sashing rows using 5 navy dot  $2\frac{1}{2}$ " squares and 4 cream dot  $16\frac{1}{2}$ " strips each. Sew 4 block rows using 5 cream  $16\frac{1}{2}$ " strips and 4 blocks each. Sew rows together, alternating.
- 9** Sew together 5 cream  $2\frac{1}{2}$ " x  $4\frac{1}{2}$ " rectangles and 4 pieced border units to make border strip. Make 4. Sew 2 to sides. Stitch 2 pieced squares to ends of remaining border strips. Sew to top and bottom.
- 10** Stitch blue floral 94" strips to sides; trim even with top and bottom. Sew remaining blue floral 94" strips to top/bottom; trim even with sides.
- 11** Layer, baste, and quilt.



**Assembly Diagram**