

web bonus: college team 1st and 10!

Designed by **Deb Luttrell**

Made by **Dotti Reynolds**

Machine Quilted by **Sandra Coffey**

Finished Quilt Size
76½" x 100½"

Number of Blocks and Finished Size

18 Broken Sash Blocks 12" x 12"

17 Louisiana Blocks 12" x 12"

shop

| | |
|--|------------|
| Purple texture (Broken Sash Blocks) | 2¾ yds. |
| Purple novelty print (Broken Sash Blocks, outer border, binding) | 4⅞ yds. |
| Yellow mottle (Louisiana Blocks, inner border) | 2⅛ yds. |
| Purple mottle and white texture (Louisiana Blocks) | 1⅜ yds. |
| Backing (piece widthwise) | 7¼ yds. |
| Batting size | 86" x 110" |

plan

Deb designed this bright, happy quilt with plenty of space to show off your favorite team's fabric! The purple novelty fabric she used is directional; be sure to cut the outer border accordingly.

cut

(in order listed)

Purple texture

72 squares 6½" x 6½"

Purple novelty print

*2 strips 6½" x 80", pieced from 4 width of fabric (WOF) strips

*2 strips 6½" x 92", cut on lengthwise grain

5 strips 2½" x 76", cut on lengthwise grain (binding)

18 squares 12½" x 12½"

Yellow mottle

*2 strips 2½" x 88", pieced from 5 WOF strips

*2 strips 2½" x 68", pieced from 4 WOF strips

136 squares 3½" x 3½"

Purple mottle and white texture—cut from each:

68 rectangles 3½" x 6½"

*Border strips include extra length for trimming.

sew

1 Draw diagonal line on wrong side of purple texture 6½" square. Referring to **Diagram I**, place marked square on purple novelty 12½" square, right sides together, aligning raw edges. Stitch on drawn line; trim away and discard excess fabric. Open and press. Repeat on all corners to make Broken Sash Block. Make 18.

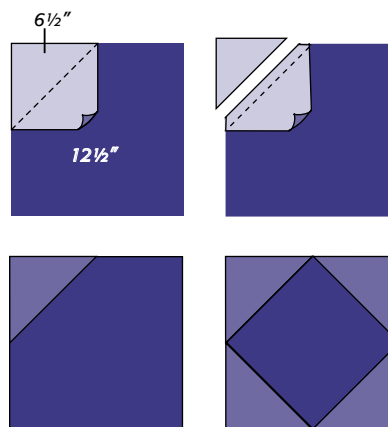

Make 18

Diagram I

- 2** Referring to Step 1 technique, add yellow mottle squares to both ends of purple mottle rectangle to make pieced rectangle (**Diagram II**). Make 68.

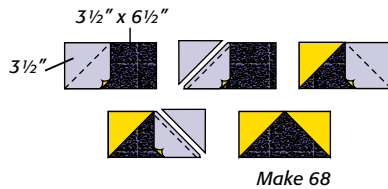

Diagram II

- 3** Watching orientation, sew white texture rectangle to pieced rectangle (**Diagram III**) to make pieced square. Make 68. Referring to **Diagram IV**, sew together 4 pieced squares to make Louisiana Block. Make 17.

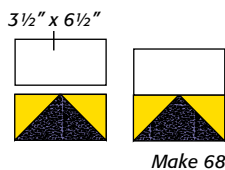

Diagram III

- 4 Note:** Refer to **Assembly Diagram** for following steps. Sew together 3 Broken Sash Blocks and 2

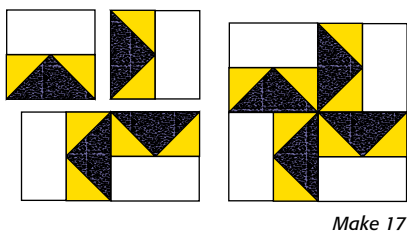
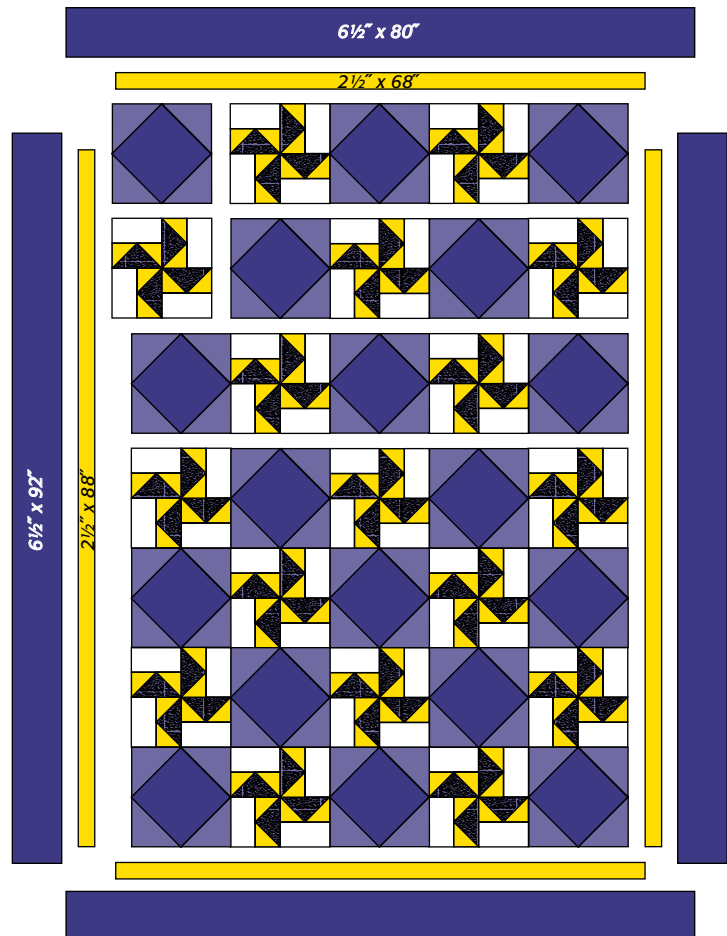

Diagram IV

Louisiana Blocks, alternating, to make block row. Make 4. Stitch together 3 Louisiana Blocks and 2 Broken Sash Blocks, alternating, to make 2nd block row. Make 3. Sew block rows together, alternating.

- 5** Sew yellow 88" strips to sides; trim even with top and bottom. Stitch remaining yellow strips to top/bottom; trim even with sides. In same manner, sew remaining border to quilt, adding side strips first and trimming even after each addition.



Assembly Diagram

- 6** Layer, baste, and quilt. Sandra machine quilted a ribbon motif in the Broken Sash Blocks and the outer border. The Louisiana Blocks feature a curlicue design, and the inner border has a continuous wave. Bind with purple novelty print.

kit offer

A kit of fabrics for quilt top and binding is available while supplies last for \$109.95 ppd. (TX residents, \$118.20 ppd.) from Stitchin' Heaven, 502 E. Goode St., Quitman, TX 75783; 800-841-3901; stitchinheaven.com. Alternate team versions are available; inquire by phone or online.

